

Fentanyl Urine Detection Kit on the RYAN Immunofluorescence Analyzer

First Ever FDA Cleared and CLIA Categorized Point-of-Care Fentanyl Test

RAPID SCREEN IN LESS THAN 6 MINUTES

The Carolina Liquid Chemistries Corp. Fentanyl Urine Detection Kit is a fluorescence immunoassay intended for the qualitative detection of fentanyl in human urine at a cutoff concentration of 1.0 ng/mL.

The assay is intended for use with the Carolina Liquid Chemistries Immunofluorescence Analyzer RYAN.



KEY POINTS

- *Next-generation testing for fentanyl in human urine*
- *Cutoff concentration at 1.0 ng/mL, specific to active parent compound*
- Qualitative screen in < 6 minutes
- Rapid use in the clinical laboratory or point-of-care
- Automated results, eliminate human subjectivity in interpretation
- Compact and portable

EXCELLENT SENSITIVITY AND SPECIFICITY

% agreement among negatives

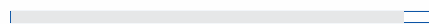

92.5%

% agreement among positives

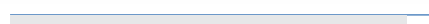

93.3%

80 clinical samples were analyzed by LC-MS/MS and by the Fentanyl (FTY) Urine Detection Kit (Fluorescence Immunochromatographic Assay). Each sample was tested using three different lots of the device.

TEST PROCEDURE

01

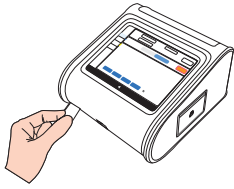

Read the ID chip first.

02



Add urine sample to the card's sample well.

03

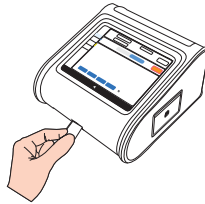

Insert the test card into the analyzer after sample loading.

04



Choose "Standard Test" then click "Start Test."

05



The analyzer will time for 5 minutes then display the result automatically on the screen.

INSTRUMENT DESCRIPTION

Name	Immunofluorescence Analyzer
Model	Carolina Liquid Chemistries Corp. RYAN
Method	Time-resolved fluorescence immunoassay
Sample Type	Urine
Speed	Results in <6 minutes. Quick mode up to 40 T/hr*
Display	8 inch color touchscreen
Language	English, Chinese, German, Russian, Spanish, Portuguese, Italian, French
Memory	50,000 test records
Connectivity	Serial Port, USB, WLAN, LIS
Size	approx. 11 x 11 x 6.3 inches (280 x 280 x 160 mm)
Weight	4.4 lbs (2 kg)



* Quick mode throughput estimate includes allowance for operator to enter patient information and handle sample.

COMMON APPLICATIONS



Laboratory



Emergency Department



Pain Management



Athletics Screening



Law Enforcement and Criminal Justice*

ORDER INFORMATION

Cat.No	Product Name	Pack Size
CLCF065025	Carolina Liquid Chemistries Corp. Fentanyl Urine Detection kit (Fluorescence Immunochromatographic Assay)	25 Tests/Kit
CLCE01106	Carolina Liquid Chemistries Corp. Immunofluorescence Analyzer RYAN	1

Manufactured for



313 Gallimore Dairy Rd, Greensboro, NC 27409 USA

Email: contactsales@carolinachemistries.com

Tel: 877-722-8910

Web: www.carolinachemistries.com

CLC FTY RYAN flyer.01 JUL 2023